

DAMAZINE FU OFFICE/GUEST HOUSE - BLUE NILE STATE/SUDAN

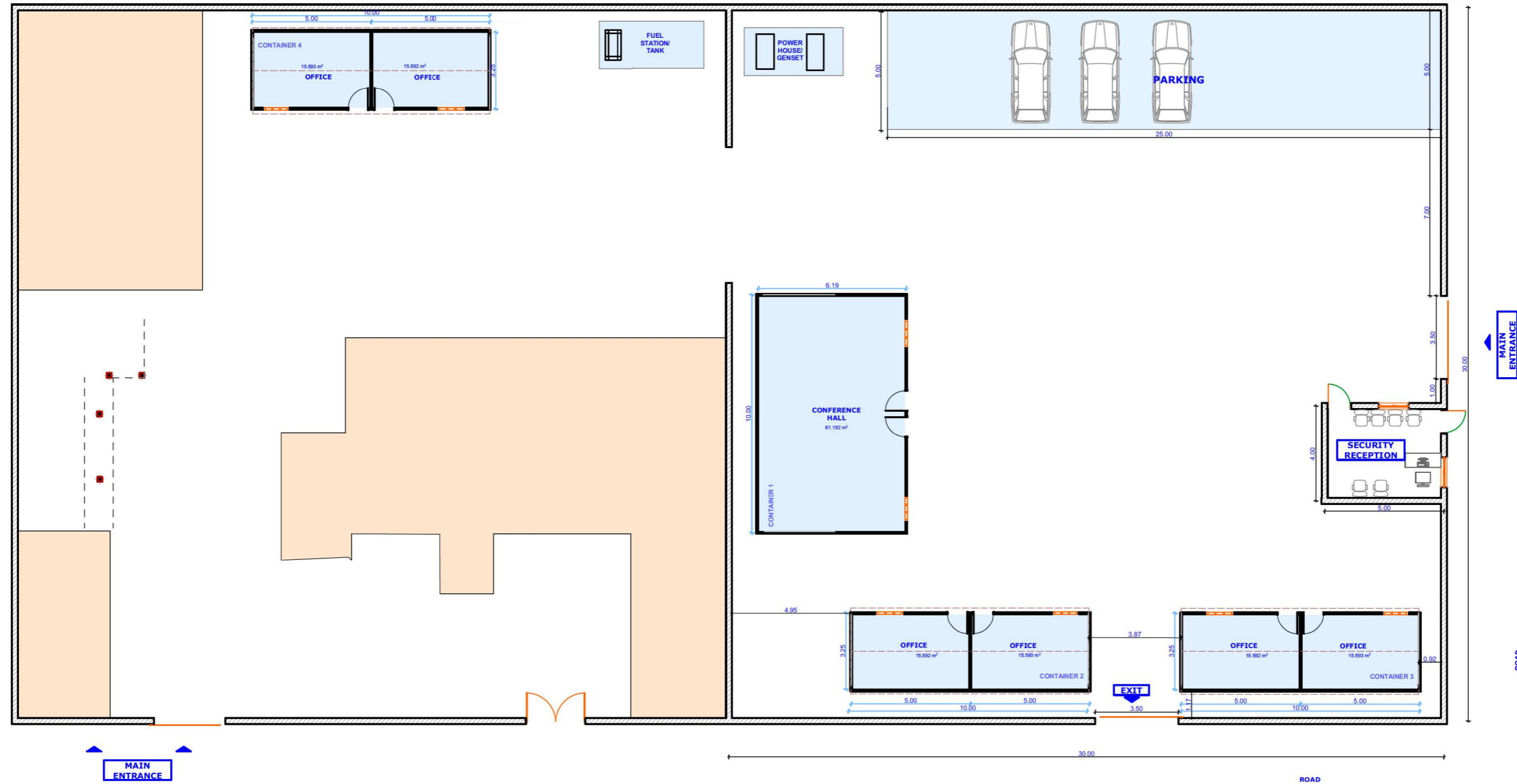

PREFAB FLOOR PLAN

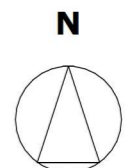

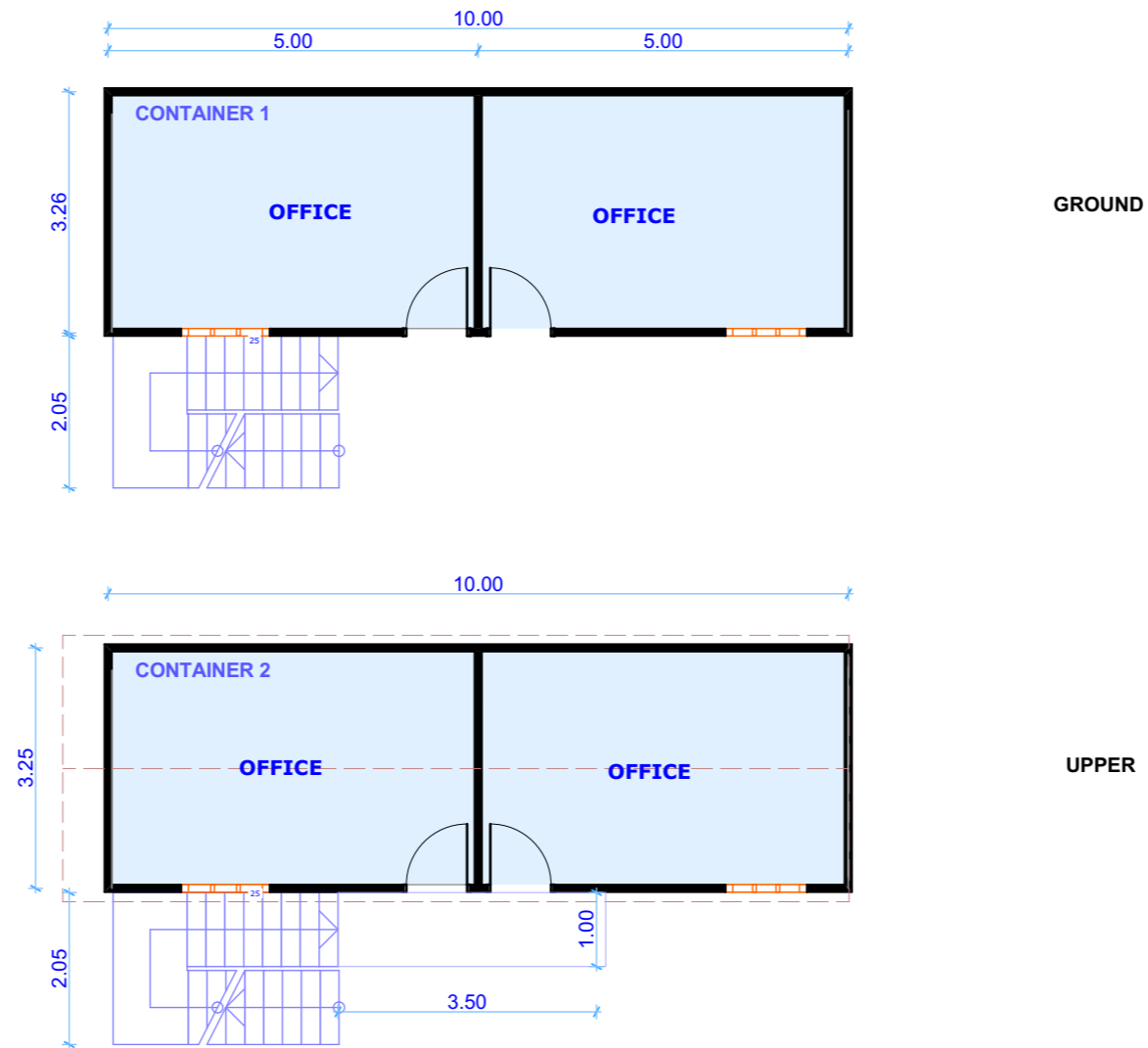

10X3.25 METERS PREFAB PLAN

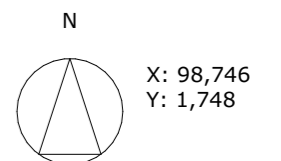

DAMAZINE FU - BLUE NILE STATE		REV.00
UNHCR SUDAN	FEEDBACK: BAKERM@UNHCR.ORG	DATE: JULY 2022

DAMAZINE FU OFFICE - BLUE NILE STATE/SUDAN

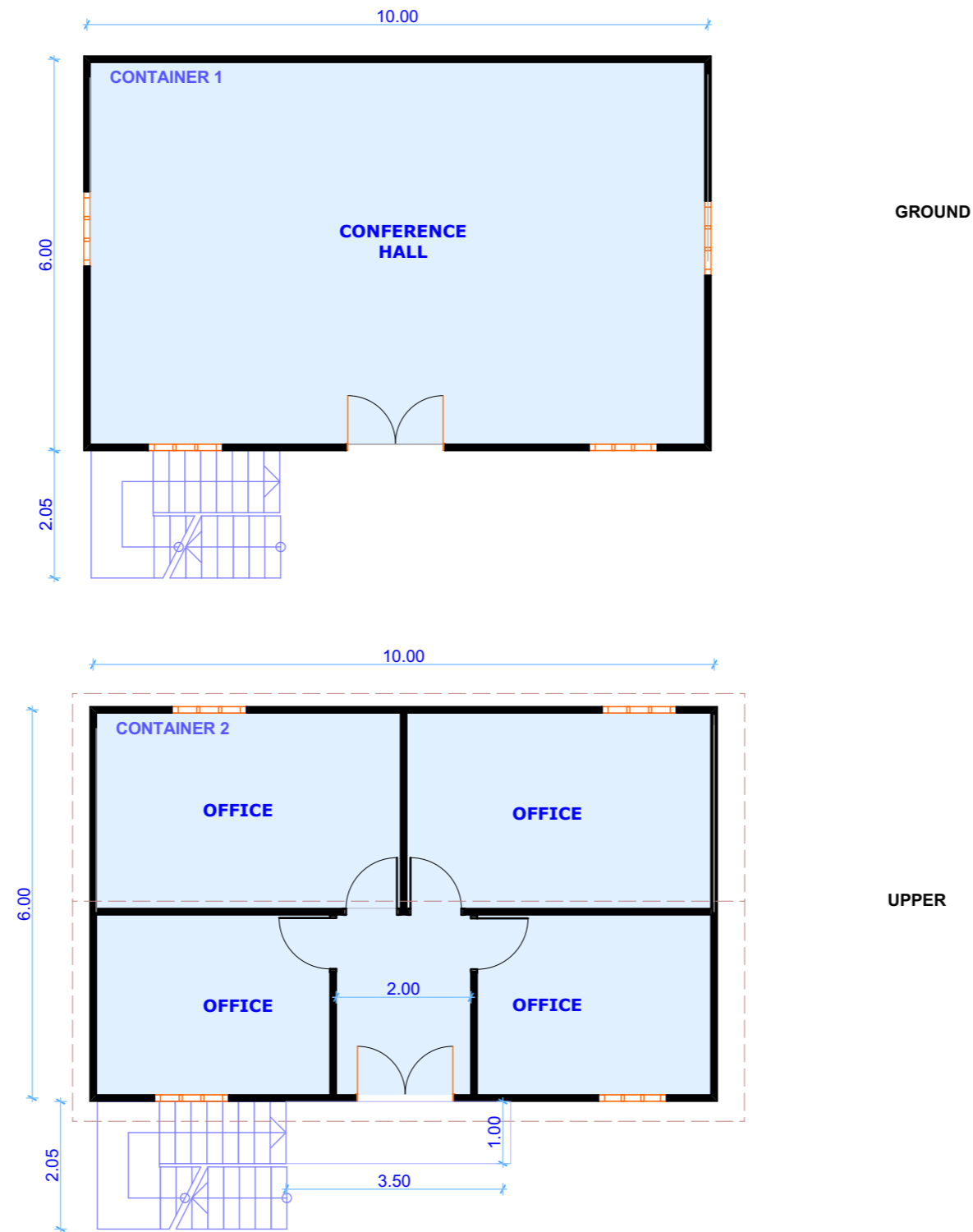



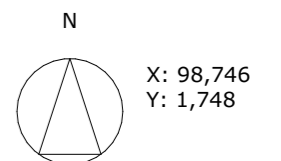

10X6.00 METERS PREFAB PLAN

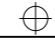

DAMAZINE FU - BLUE NILE STATE		REV.00
UNHCR SUDAN	FEEDBACK: BAKERM@UNHCR.ORG	DATE: JULY 2022

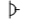
DAMAZINE FU OFFICE - BLUE NILE STATE/SUDAN

SYMBOL	DESCRIPTION
	CEILING LED LAMP
	AIR CONDITION
	13 AMP SOCKET
	AC SOCKET

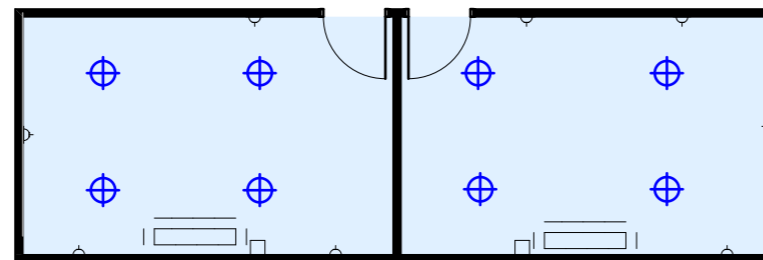

CONTAINER ELECTRICAL PLAN

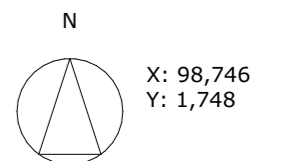



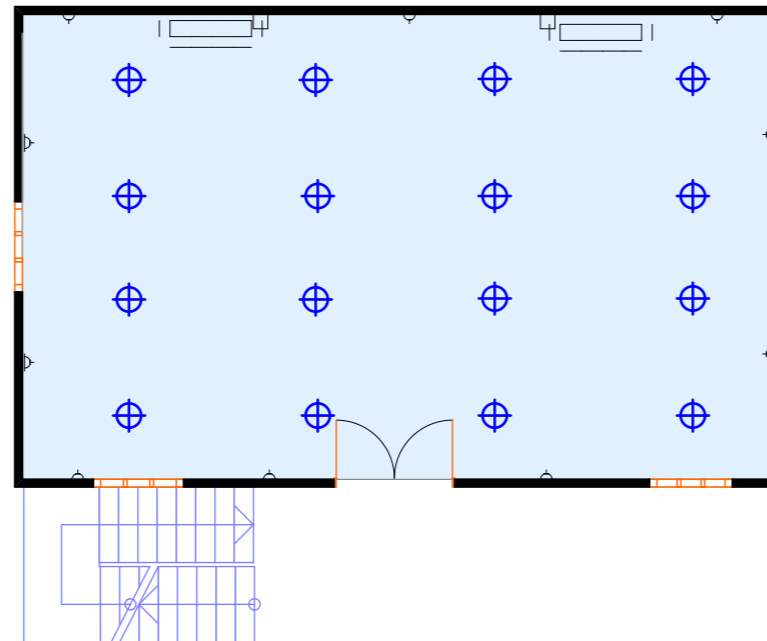

DAMAZINE FU - BLUE NILE STATE	REV.00
UNHCR SUDAN FEEDBACK: BAKERM@UNHCR.ORG	DATE: JULY 2022

DAMAZINE FU OFFICE - BLUE NILE STATE/SUDAN



GROUND

SYMBOL	DESCRIPTION
	CEILING LED LAMP
	AIR CONDITION
	13 AMP SOCKET
	AC SOCKET

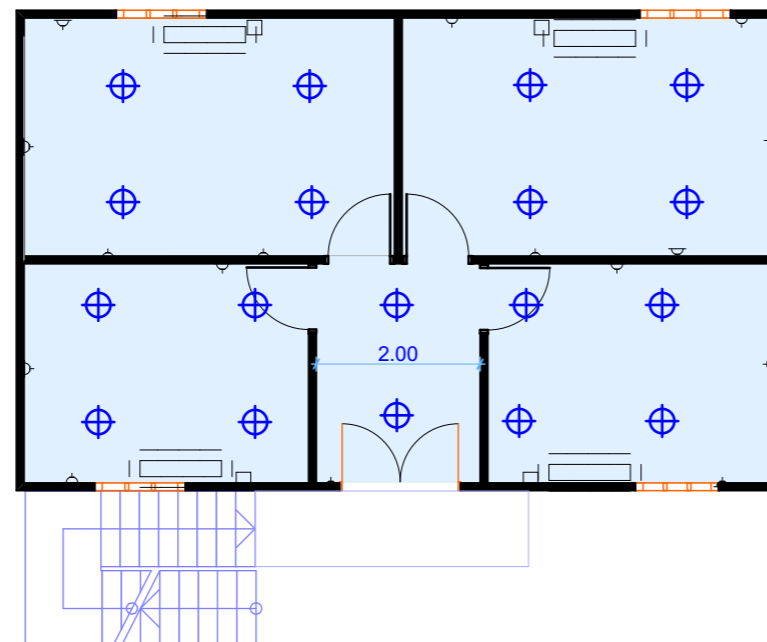

UPPER

CONTAINER ELECTRICAL PLAN

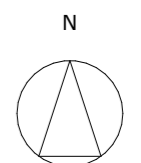

X: 98,746
Y: 1,748

DAMAZINE FU - BLUE NILE STATE		REV.00
UNHCR SUDAN	FEEDBACK: BAKERM@UNHCR.ORG	DATE: JULY 2022

DOORS & WINDOWS

TYPE	W	H	REMARKS
D1	1.00	2.00	INCLUDE FRAME
W1	1.30	1.00	INCLUDE FRAME

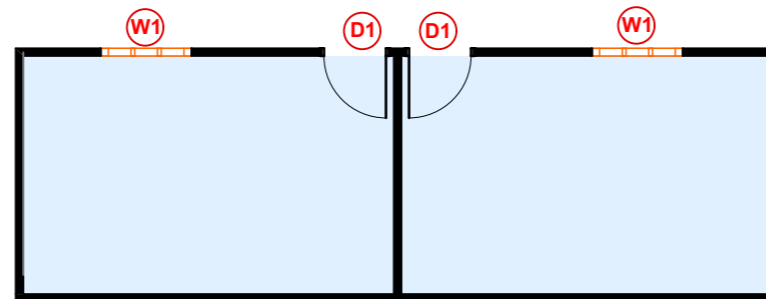

DOORS AND WINDOWS

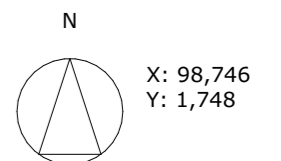

DAMAZINE FU - BLUE NILE STATE		REV.00
UNHCR SUDAN	FEEDBACK: BAKERM@UNHCR.ORG	DATE: JULY 2022

DAMAZINE FU OFFICE - BLUE NILE STATE/SUDAN

DOORS & WINDOWS

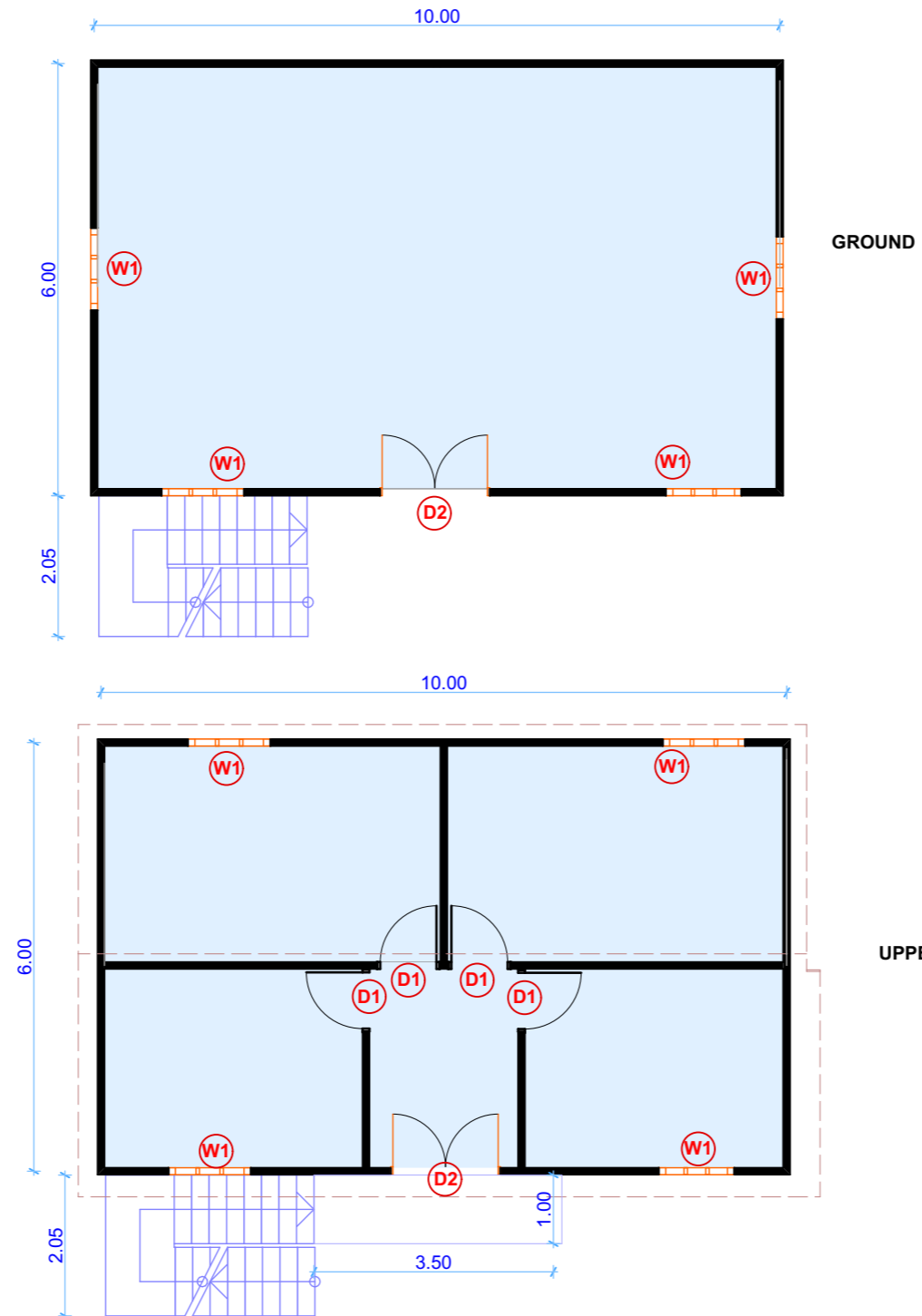

TYPE	W	H	REMARKS
D1	1.00	2.00	INCLUDE FRAME
D2	1.80	2.00	INCLUDE FRAME
W1	1.30	1.00	INCLUDE FRAME

DOORS AND WINDOWS

